

19, Cyril Bell Close, Lymm, WA13 0JS

£230,000

🛏️ 2 🚿 1 🚗 1



Having been re-decorated and painted this two bedroom first floor retirement apartment is situated in a sought after location within walking distance of Lymm village centre and all of its amenities. This property is only available for people aged 55 years and over and has the advantage of an on site 24 hour warden and is being offered for sale with NO ONWARD CHAIN.

Key Features

- No Onward Chain
- Secure communal entrance
- Communal gardens
- On-site laundry
- Emergency pull cord system throughout the apartment together with passive controlled movement sensor
- Two bedroom first floor retirement Apartment, newly carpeted, decorated and painted
- Located within easy reach of Lymm village centre
- Warden based on site should assistance be required
- Electric storage heaters
- Viewings highly recommended

674 sq.ft. (62.6 sq.m.) approx.

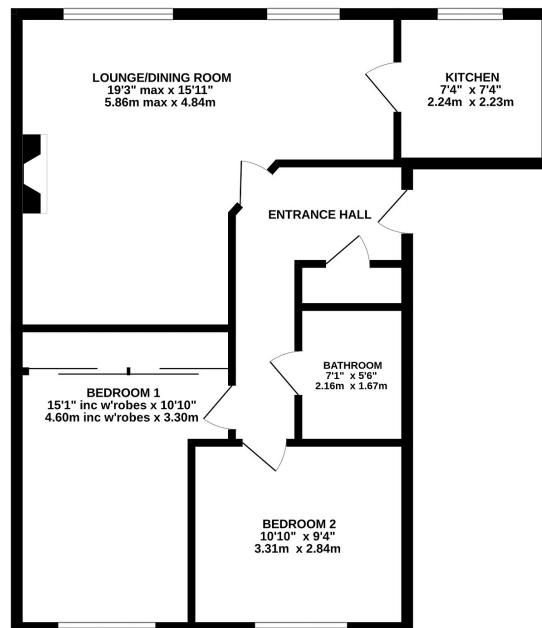

TOTAL FLOOR AREA: 674 sq.ft. (62.6 sq.m.) approx.
Whilst every attempt has been made to ensure the accuracy of the floorplan contained here, measurements of doors, windows, rooms and any other items are approximate and no responsibility is taken for any error, omission or misstatement. This plan is for illustrative purposes only and should be used as such by any prospective purchaser. The services, systems and appliances shown have not been tested and no guarantee as to their operability or efficiency can be given.
Made with Metropix C0202